



August 2020
 TH&A Monthly Training
www.THAHD.com

*Thomasville Experience:
 Setting Wall Properties and
 Preparing for a Design*

Do you have a
 20-20 question?

Ask your
 Thomasville Representative!

TH&A

Todd Haley & Associates

www.thomasvillecabinetry.com
www.homedepot.com

Thomasville Experience: Setting Wall Properties And Preparing for a Design

*Set your wall
 properties before you
 start placing cabinets.*

Right-Click on any of your walls,
 then select "Properties"

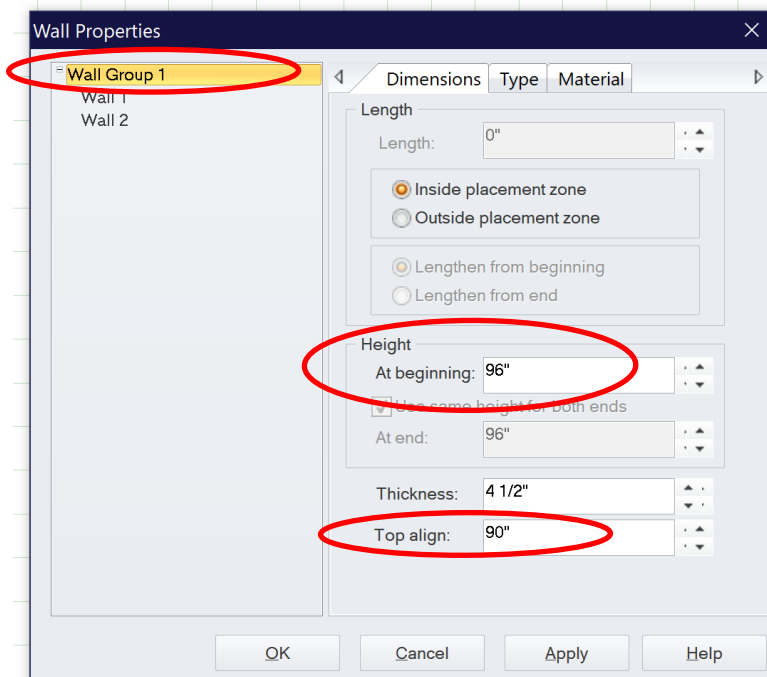
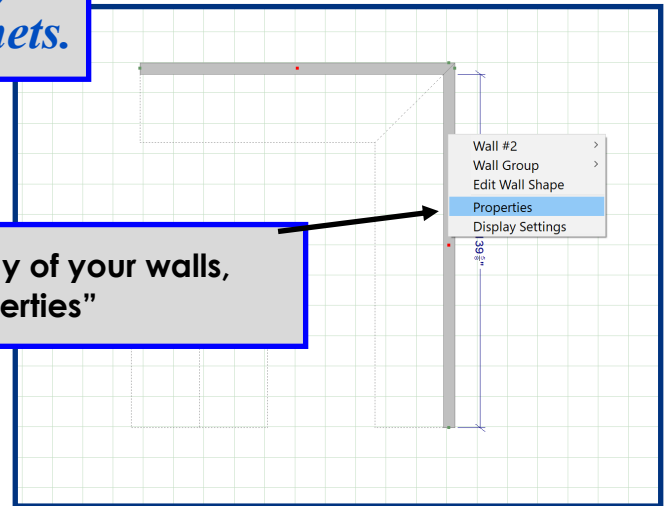

STANDARD
 TOP-ALIGN
 FOR WALL
 CABINETS

30" - 84"
 33" - 87"
 36" - 90"
 39" - 93"

- Highlight the desired WALL GROUP, (or individual walls if needed)
- Set the HEIGHT of your walls
- Set your TOP-ALIGN according to your wall cabinet height— wall cabinets will automatically drop in at this height

See Next Page to continue:

Thomasville Experience: Setting Wall Properties

Creating double-sided placement zones for islands

Select both *inside and outside* placement zones under wall properties

Or

Use the Double-Sided Continuous Line when creating the wall

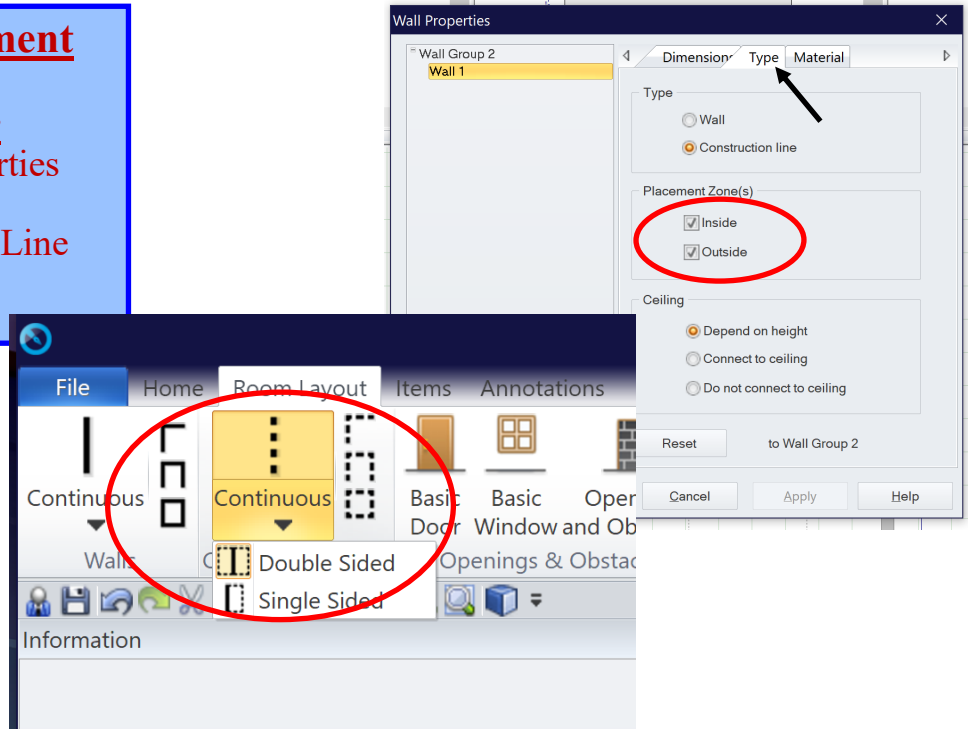

Opening Multiple Elevations at Once

If you've already placed cabinets, go to the "Architecture Tab" to view your layout without cabinets

- Hold the "Control" Key on your keyboard
- Select All of your needed Placement Zones
- Double-Click in one of the selected Placement Zones
- This will open all of your elevations in one tab, side-by-side

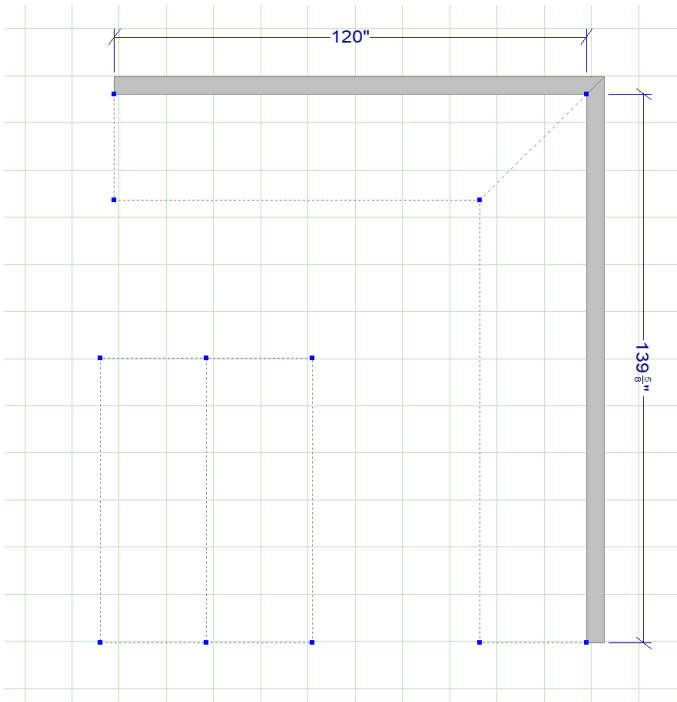
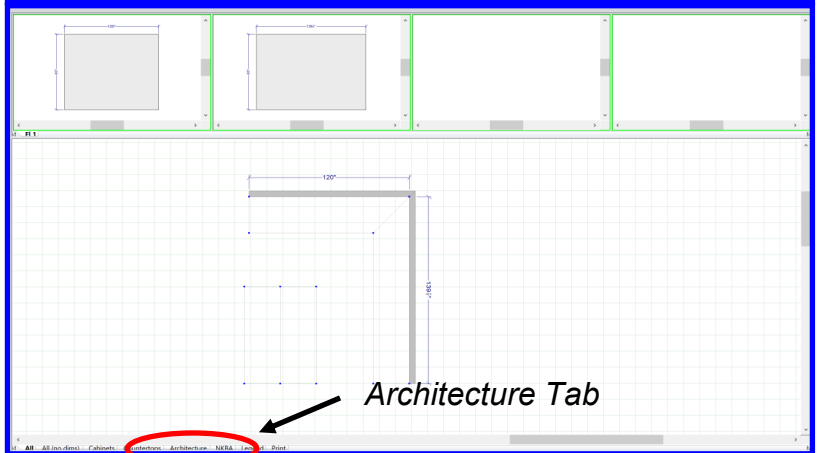

*Thomasville Cabinetry
Available only at Home Depot!
We are Home Depot!*

