



June 2020

TH&amp;A Monthly Training

*Highlight Fillers for the  
DIY Customer or Installer*

Do you have a  
20-20 question?

Ask your MasterBrand  
Representative!

# TH&A

Todd Haley &amp; Associates

## Ginny Edens

Your Store Representative

770-424-7518 office  
gedens@toddhaley.com

## Josh Wilson

205-259-8141 cell  
jwilson@toddhaley.com

## Judson Haley

770-769-6809 cell  
jhaley@toddhaley.com

## Michelle Hlavaty

678-468-5103  
michelleh@toddhaley.com

## Mike Wilson

770-310-5710 cell  
mwilson@toddhaley.com

## Paul Cunningham

615-681-2686 cell  
pcunningham@toddhaley.com

## Sherry Grooms

910-367-3913  
sgrooms@toddhaley.com

## Thomas D. Clarke

225-240-0529 cell  
tclarke@toddhaley.com

## Valerie Hurst

704-493-4977 cell  
vhurst@toddhaley.com

www.thomasvillecabinetry.com  
www.homedepot.com

## Thomasville Experience: Highlight Fillers for the DIY Customer or Installer

If you have ever received a call requesting a site inspection by a customer that claims the cabinets just don't fit, you're not alone. As a designer you can talk until you are blue in the face with a DIY Customer or Contractor about fillers and they may have no idea what you are talking about. Let's face it, people have different skill sets but if you've never installed cabinets you just may not know. This tip is for those Novice Installers or DIY customers that have never had to use fillers. Let's help them "see" where they are on the Floor Plan and Elevations.

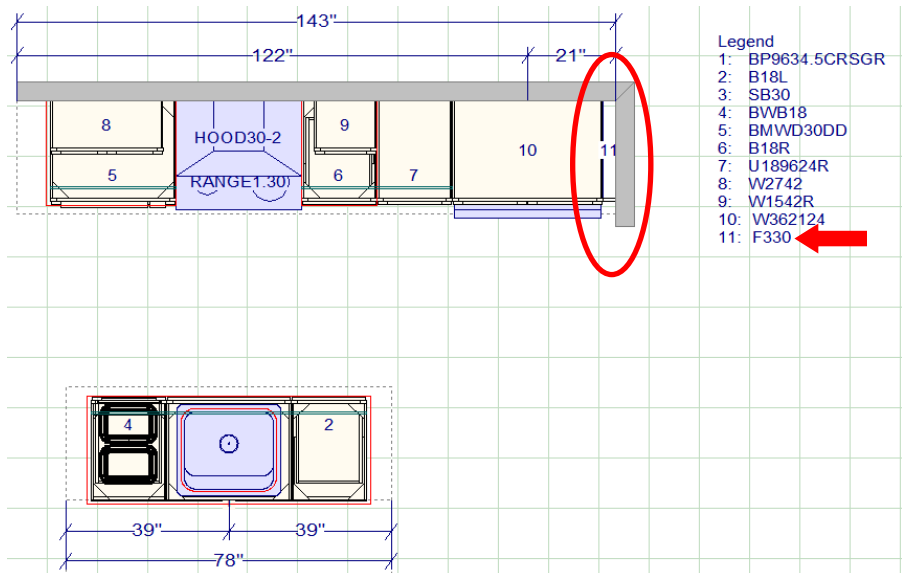

In this simple kitchen layout, a filler has been used against the wall above the refrigerator to allow the refrigerator door to swing past 90° so that the internal vegetable drawer will pull out without hitting the door.

#11 on the Legend is listed as a F330.

*See Next Page to continue:*

**Thomasville Experience: Highlight Fillers for the DIY Customer or Installer**

To make sure the person installing this set of cabinets understands what they are seeing, lets make some changes. Right click on the Floor Plan away from your design and select Display Settings.

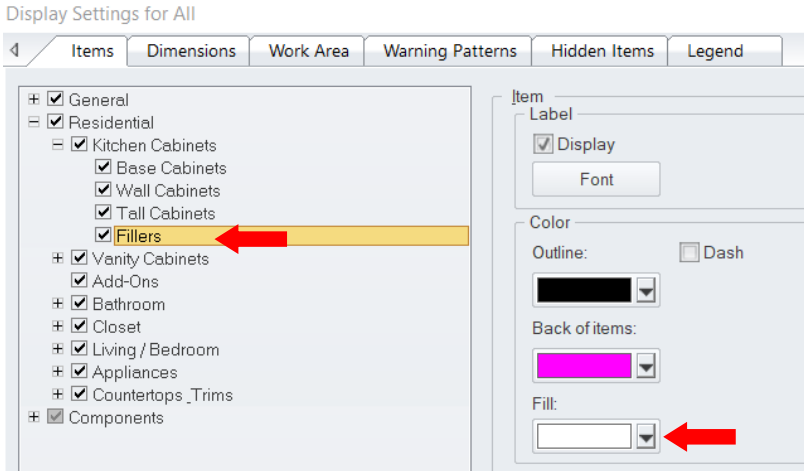
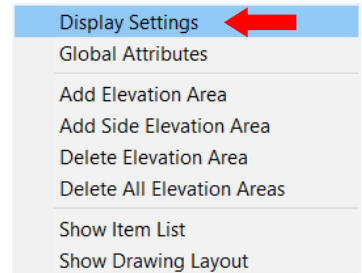

Under the Items tab find Fillers in the Residential category.

Notice the Fill box is white, change it to your desired Highlighted color.

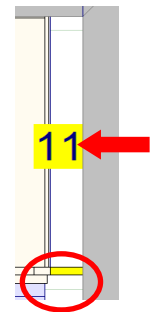
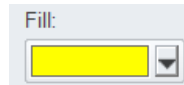

Your filler & legend # will now display your selected color. Follow these same steps on each of your elevations.

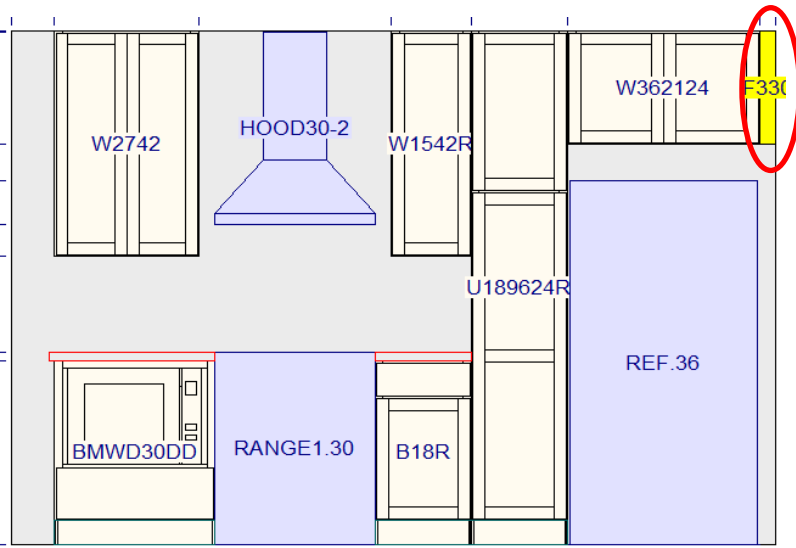

**It's that Easy!**

**Thomasville,  
We Are Home Depot!**

*Thomasville Cabinetry  
Available only at Home Depot!  
We are Home Depot!*

